

# CG-1968-T-50

## DRAIN VALVE ASSEMBLY INSTRUCTIONS

### CG-1968-T-50 3" DRAIN VALVE, ZERO DEAD SPACE, IMPROVED, PILOT PLANT, STANDARD

Our detachable zero dead space drain valve has two Perfluoro o-rings installed on the shaft and one Perfluoro o-ring installed on the tip. A FEP encapsulated silicone o-ring is also supplied for attachment to the tip in low temperature applications. The drain valve is connected to the reactor by a unique 3" beaded pipe valve seat and has a 1-1/2" beaded pipe side arm.

**PLEASE NOTICE TEMPERATURE LIMITATIONS ON O-RINGS AND RECOMMENDED TORQUE SETTING FOR BEADED PIPE COUPLINGS LISTED BELOW BEFORE USING THIS VALVE.**

| <u>O-Ring Material</u> | <u>Color</u> | <u>Temperature Range (°C)</u> | <u>Beaded Pipe Coupling</u> | <u>Recommended Torque Setting</u> |
|------------------------|--------------|-------------------------------|-----------------------------|-----------------------------------|
| Perfluoro              | Black        | -7 to 230                     | 1-1/2"                      | 50 in-lbs                         |
| FEP-Silicone           | Orange       | -62 to 205                    | 3"                          | 75 in-lbs                         |

### Attaching the valve to the reactor:

- Wet coupling and the beaded pipe ends, on the reactor and valve, with water
- Snap the coupling over the valve seat on the reactor
- Snap the valve assembly into other side of the coupling. Plug must be in the open position
- Tighten the coupling with a torque wrench to the recommended torque setting

**PLEASE NOTE: PLUG MUST BE IN THE OPEN POSITION TO INSTALL OR REMOVE**

| REV. | DESCRIPTION     | DATE      | EDITED BY |
|------|-----------------|-----------|-----------|
| A    | CREATED DRAWING | 10/5/2016 | CLC       |

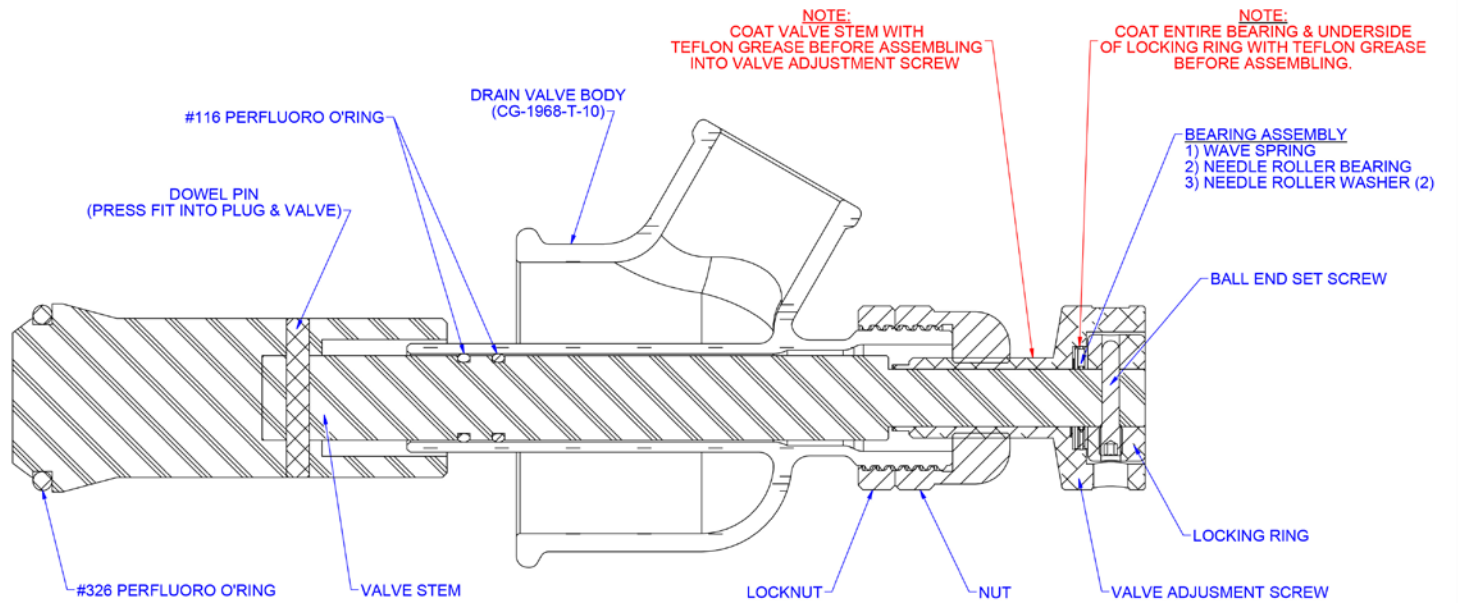
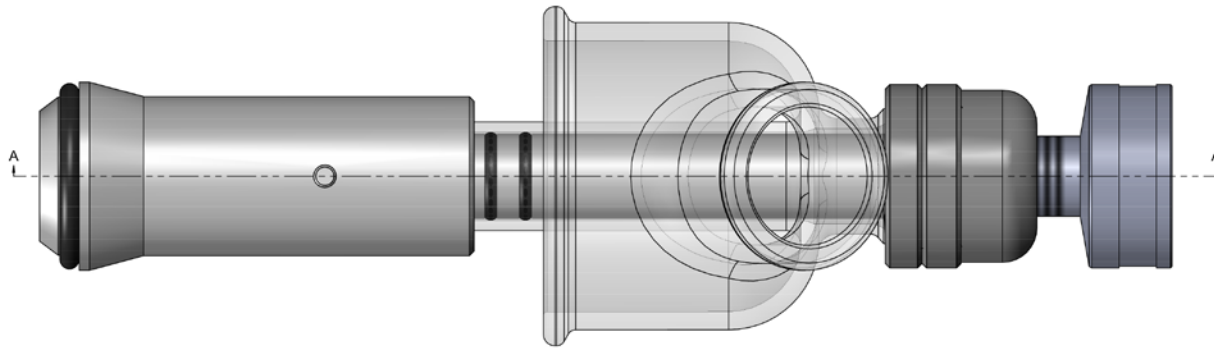
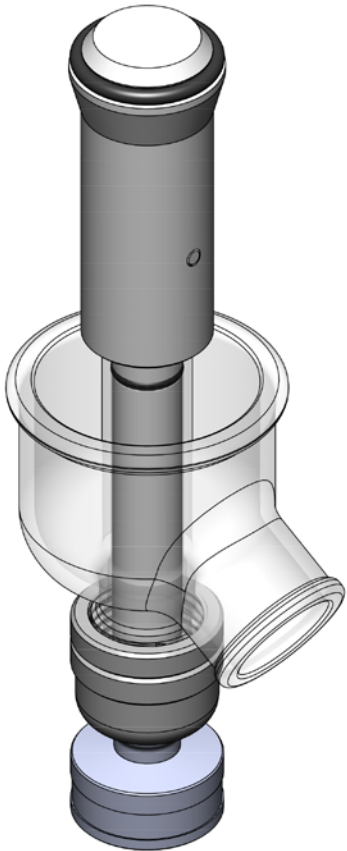

SECTION A-A  
SCALE 1 : 1.25

|  |  |   |                         |                       |  |                   |
|--|--|---|-------------------------|-----------------------|--|-------------------|
| TITLE:<br><b>3" ZERO DEAD SPACE DRAIN VALVE ASSEMBLY</b> | PARTS:<br><b>CG-1968-T-50-ASSEMBLY</b> | REV:<br><b>A</b>  | CUSTOMER:<br><b>CLS</b> | REFR.:                | SCALE:<br><b>1:1</b>   | SIZE:<br><b>B</b> |
| APPROVAL:  | DATE:                                  | N:\SOLIDWORKS\CHEMGLASS CATALOG\ZERO DEAD SPACE DRAIN VALVES\ |                         | AUTHOR:<br><b>CLC</b> | <b>CHEMGLASS</b><br>3861 NORTH MILL ROAD<br>VINELAND, NJ 08360<br><small>THIS INFORMATION IS THE PROPERTY OF CHEMGLASS, INC. AND IS REPRODUCED FOR PUBLICATION OR DISTRIBUTION TO A THIRD PARTY IS STRICTLY FORBIDDEN. UNLESS WRITTEN PERMISSION IS GIVEN BY AN AUTHORIZED AGENT OF CHEMGLASS.</small> |                   |